

100 ha "Square farm" Scenarios

Ex. 1: DAIRY

Rule 1

Trees	Runoff
3	24
Effluent	Platform
58	51

25ha@3 = 75
 75ha@24 = 600
 25ha@58 = 1450
 25ha@51 = 1275

100ha = 3 food kg

BENCHMARK = 34 kg/ha

New rules

Trees	Runoff
3	13
Effluent	Platform
35	35

25ha@3 = 75
 25ha@13 = 325
 50ha@35 = 1750
 100ha = 2150kg

NDA = 21.5 kg/ha

Ex. 2: Drystock

Rule 1

Trees	Drystock
3	14
Drystock	Dairy support
22	26

25ha@3 = 75
 25ha@14 = 350
 25ha@22 = 550
 25ha@26 = 650

100ha = 1625 kg

BENCHMARK = 16.25 kg/ha

New rules

Trees	Drystock
3	13
Drystock	Dairy Support
13	13

25ha@3 = 75
 75ha@13 = 975
 100ha = 1050

NDA = 10.5 kg/ha

Ex. 3. Change to higher intensity

Rule II

01-04

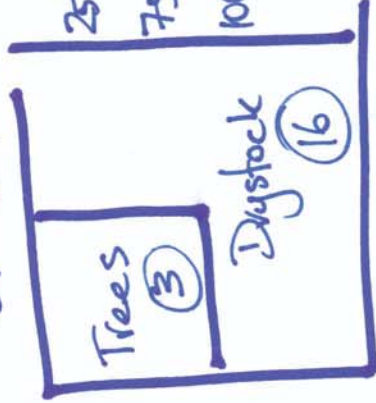

25ha @ 3 = 75
75ha @ 16 = 1200
100ha = 1275kg



current

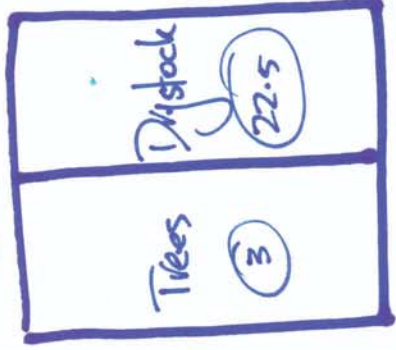

50 @ 3 = 150
50 @ 22.5 = 1125
100ha = 1275kg

BENCHMARK = 12.75 kg/ha

BENCHMARK = 12.75 kg/ha

New rules

IF START POINT =

01-04

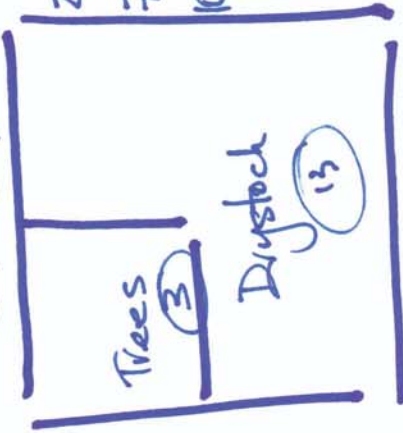

25ha @ 3 = 75
75ha @ 13 = 975
100ha = 1050kg

OR

IF START POINT =

NOW



5ha @ 3 = 150
50ha @ 13 = 650
100ha = 800kg

NDA = 10.5 kg/ha

NDA = 8 kg/ha

Ex. 4. Increase in effective area

Rule 11

01-04

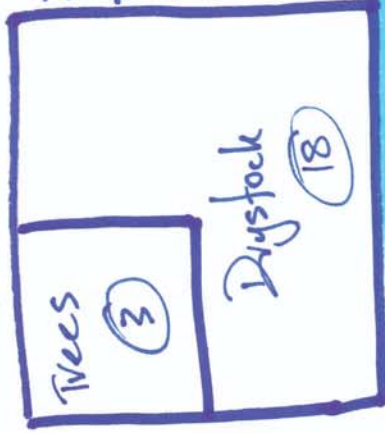

25 ha @ 3 = 75
75 ha @ 18 = 1350
100 ha = 1425 kg



current



100 ha @ 14.25 = 1425

BENCHMARK = 14.25 kg/ha

BENCHMARK = 14.25 kg/ha

New rules

IF START POINT =
01-04

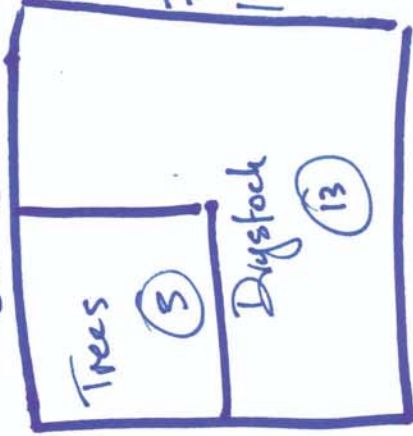

25 ha @ 3 = 75
75 ha @ 13 = 975
100 ha = 1050 kg

IF START POINT =
NOW

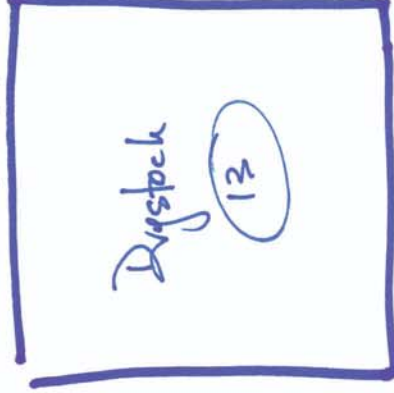

100 ha @ 13 = 1300 kg

NDA = 10.5 kg/ha

NDA = 13 kg/ha